

FIGURE 210. TANDEM AXLE HUB AND DRUM ASSEMBLY (MODEL M915).

T217131

SECTION II (1)	ITEM (2)	(3)	TM9-2320-273-24P (4)	(5)	(6)
NO	SMR CODE	FSCM	PART NUMBER	DESCRIPTION AND USABLE ON CODE (UOC)	QTY
GROUP:1311 WHEEL ASSEMBLY					
FIGURE 210. TANDEM AXLE HUB AND DRUM ASSEMBLY (MODEL M915).					
1	PAOZZ	78500	1199B1666	RING,WIPER INNER UOC:U21	1
2	PAOZZ	65282	839495	SEAL,PLAIN,ENCASED OIL, INNER UOC:U21	1
3	PAOZZ	78500	598A	CONE AND ROLLERS,TA INNER UOC:U21	1
4	PAOZZ	78500	S255C	SCREW,CAP UOC:U21	5
5	PAOZZ	19207	11601651	WASHER,FLAT UOC:U21	5
6	PAOZZ	78500	3286-C-445	DEFLECTOR,DIRT UOC:U21	1
7	PAOOO	78500	A66-333-Q-2331	HUB AND DRUM ASSY RH UOC:U21	1
7	PAOOO	78500	A65-333-Q-2331	BRAKE DRUM ASSEMBLY LH UOC:U21	1
8	PAOOO	78500	A2-333-Q-2331	.HUB AND STUD ASSY RH UOC:U21	1
8	PAOOO	78500	A1-333-Q-2331	.HUB AND STUD ASSY LH UOC:U21	1
9	PAOZZ	78500	572	.CUP,TAPERED ROLLER OUTER UOC:U21	1
10	PAOZZ	78500	592A	.CUP,TAPERED ROLLER INNER UOC:U21	1
11	PAOZZ	78500	20-X-1464	.STUD,PLAIN RH UOC:U21	10
11	PAOZZ	78500	20-X-1463	.STUD,PLAIN LH UOC:U21	10
12	PAOZZ	78500	1199J114	.NUT CAP ASSEMBLY INNER, RH	10
13	PAOZZ	78500	1199N118	.NUT,CAP PUTER RH UOC:U21	10
13	PAOZZ	96906	MS51983-3	.NUT,PLAIN,SINGLE BA LH UOC:U21	10
14	PAOZZ	78500	580	.CONE AND ROLLERS,TA OUTER UOC:U21	1
15	PAOZZ	78500	1227W517	.NUT,WHEEL BEARING UOC:U21	1
16	PAOZZ	78500	1229U1009	.WASHER,KEY UOC:U21	1
17	PAOZZ	78500	1227-R-330	.NUT,PLAIN,HEXAGON UOC:U21	1
18	PAOZZ	78500	A-1199-S-1917	.WIPER OUTER UOC:U21	1
19	PAOZZ	78500	A1205N612	.SEAL ASSEMBLY,BEARI UOC:U21	1
20	PAOFF	78500	3219-G-3933	.BRAKE DRUM UOC:U21	1

END OF FIGURE

Equipment Sales

SECTION II

TM9-2320-273-24P

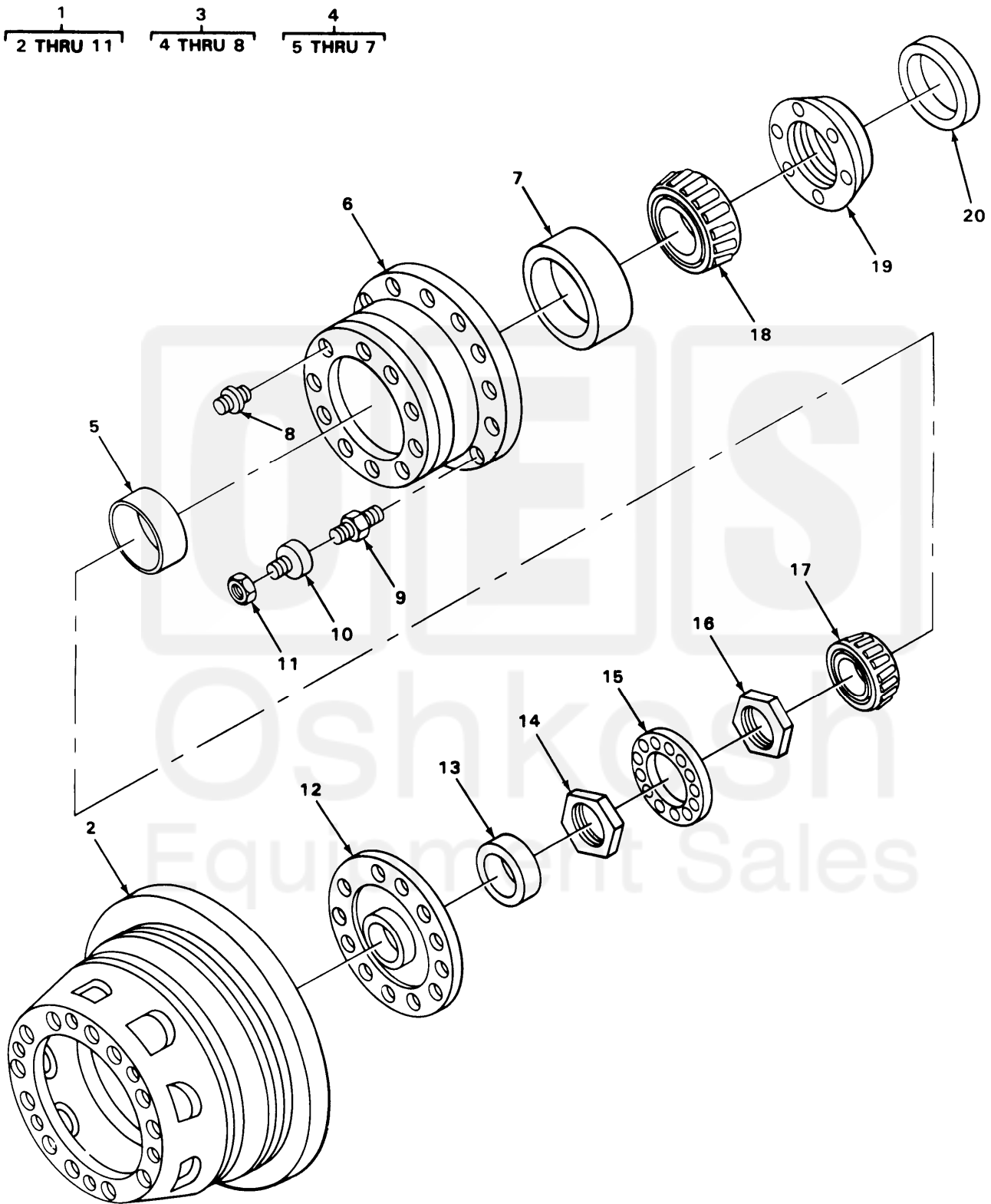

TA217133

FIGURE 212, TANDEM AXLE HUB AND DRUM ASSEMBLY
(M916, M917, M919, M919, AND M920)

Current part is item (16,15) on diagram. Available at www.oshkoshequipment.com

SECTION II (1)	SMR (2)	FSCM (3)	TM9-2320-273-24P PART NUMBER (4)	DESCRIPTION AND USABLE ON CODE (UOC) GROUP:1311 WHEEL ASSEMBLY FIGURE 212. TANDEM AXLE HUB AND DRUM ASSEMBLY (MODELS M916, M917, M918, M919 AND M920). HUB,AND,DRUM,REAR LH UOC:U22,U23,U24,U25,U26 HUB,DRUM,REAR RH UOC:U22,U23,U24,U25,U26 .BRAKE DRUM UOC:U22,U23,U24,U25,U26 .HUB AND STUD UOC:U22,U23,U24,U25,U26 ..HUB AND CUP ASSY UOC:U22,U23,U24,U25,U26 ...CUP,TAPERED ROLLER UOC:U22,U23,U24,U25,U26 ...HUB UOC:U22,U23,U24,U25,U26 ...CUP,TAPERED ROLLER OUTER UOC:U22,U23,U24,U25,U26 ..STUD UOC:U22,U23,U24,U25,U26 .STUD WHEEL,LH UOC:U22,U23,U24,U25,U26 .STUD,LOCKED IN RH UOC:U22,U23,U24,U25,U26 .NUT,CAP,DUAL WHEEL LH UOC:U22,U23,U24,U25,U26 .NUT CAP ASSEMBLY RH UOC:U22,U23,U24,U25,U26 .NUT,PLAIN,SINGLE BA LH UOC:U22,U23,U24,U25,U26 .NUT,CAP PUTER RH UOC:U22,U23,U24,U25,U26 SEAL,OIL OUTER UOC:U22,U23,U24,U25,U26 SEAL,OIL WIPER UOC:U22,U23,U24,U25,U26 NUT,PLAIN,HEXAGON UOC:U22,U23,U24,U25,U26 WASHER,KEY UOC:U22,U23,U24,U25,U26 NUT,WHEEL BEARING UOC:U22,U23,U24,U25,U26 CONE AND ROLLERS,TA UOC:U22,U23,U24,U25,U26 CONE AND ROLLERS,TA UOC:U22,U23,U24,U25,U26 SEAL UOC:U22,U23,U24,U25,U26	QTY (6)
1	PAOOO	78500	A3-333-M-1365	HUB,AND,DRUM,REAR LH UOC:U22,U23,U24,U25,U26	1
1	PAOOO	78500	A2-333-M-1365	HUB,DRUM,REAR RH UOC:U22,U23,U24,U25,U26	1
2	PAOFF	78500	A1-3219-W-2623	.BRAKE DRUM UOC:U22,U23,U24,U25,U26	1
3	PAOOO	78500	A1-333-M-1365	.HUB AND STUD UOC:U22,U23,U24,U25,U26	1
4	PAOOO	78500	A-333-M-1365	..HUB AND CUP ASSY UOC:U22,U23,U24,U25,U26	1
5	PAOZZ	55396	A0S545-10	...CUP,TAPERED ROLLER UOC:U22,U23,U24,U25,U26	1
6	XAOZZ	78500	333-M01365	...HUB UOC:U22,U23,U24,U25,U26	1
7	PAOZZ	78500	742	...CUP,TAPERED ROLLER OUTER UOC:U22,U23,U24,U25,U26	1
8	PAOZZ	78500	SC-1023	..STUD UOC:U22,U23,U24,U25,U26	10
9	PAOZZ	78500	20X-853	.STUD WHEEL,LH UOC:U22,U23,U24,U25,U26	10
9	PAOZZ	78500	20X852	.STUD,LOCKED IN RH UOC:U22,U23,U24,U25,U26	10
10	PAOZZ	96906	MS53068-1	.NUT,CAP,DUAL WHEEL LH UOC:U22,U23,U24,U25,U26	10
10	PAOZZ	78500	1199J114	.NUT CAP ASSEMBLY RH UOC:U22,U23,U24,U25,U26	10
11	PAOZZ	96906	MS51983-3	.NUT,PLAIN,SINGLE BA LH UOC:U22,U23,U24,U25,U26	10
11	PAOZZ	78500	1199N118	.NUT,CAP PUTER RH UOC:U22,U23,U24,U25,U26	10
12	PAOZZ	78500	A1205U619	SEAL,OIL OUTER UOC:U22,U23,U24,U25,U26	1
13	PAOZZ	78500	A1199H1698	SEAL,OIL WIPER UOC:U22,U23,U24,U25,U26	1
14	PAOZZ	78500	1227-R-330	NUT,PLAIN,HEXAGON UOC:U22,U23,U24,U25,U26	1
15	PAOZZ	78500	1229U1009	WASHER,KEY UOC:U22,U23,U24,U25,U26	1
16	PAOZZ	78500	1227W517	NUT,WHEEL BEARING UOC:U22,U23,U24,U25,U26	1
17	PAOZZ	78500	749	CONE AND ROLLERS,TA UOC:U22,U23,U24,U25,U26	1
18	PAOZZ	89346	31630H	CONE AND ROLLERS,TA UOC:U22,U23,U24,U25,U26	1
19	PAOZZ	02397	A1205T774	SEAL UOC:U22,U23,U24,U25,U26	1

Current part is item (16,15) on diagram. Available at www.oshkoshequipment.com